



# ADULT BIBLE STUDIES

AT FIRST BAPTIST ARLINGTON

# STAFF CONTACTS



**CURT GRICE**

Associate Pastor of Spiritual Formation

[curt.grice@fbca.org](mailto:curt.grice@fbca.org)



**BRAD ECHOLS**

Minister To Adults

[brad.echols@fbca.org](mailto:brad.echols@fbca.org)



**RYAN CHANDLER**

Young Adult Minister

[ryan.chandler@fbca.org](mailto:ryan.chandler@fbca.org)



**BRIAN SEPULVEDA**

Minister of Traditionals Care

[brian.sepulveda@fbca.org](mailto:brian.sepulveda@fbca.org)



**KURT KRODLE**

Youth Minister & Median Families Team Lead

[kurt.krodle@fbca.org](mailto:kurt.krodle@fbca.org)



**LORI ALLEN**

Spiritual Formation Ministry Assistant

[lori.allen@fbca.org](mailto:lori.allen@fbca.org)



**ANGELA HICKS**

Young Families Team Assistant

[angela.hicks@fbca.org](mailto:angela.hicks@fbca.org)

# WELCOME!

Welcome to First Baptist Church! Our mission is to “glorify God by following The Jesus Way.” We have each been created in God’s image with the opportunity (and responsibility) to give him the glory and honor he deserves. We do that best by following the Person and Way of Jesus.

Jesus is the way God has come to us. Jesus is the way we come to God. Jesus said, “I am the way and the truth and the life. No one comes to the Father except through me” (John 14:6). Once we confess that “Jesus is Lord,” we begin the journey with him.

When we declare our allegiance to King Jesus... pledging our life and loyalty to him... we become citizens of his kingdom. We pray that “his kingdom would come and his will be done on earth as it is in heaven” (Matthew 6:10).

Together, as followers of Jesus, we become “a chosen people, a royal priesthood, a holy nation, a people belonging to God, that you may declare the praises of him who called you out of darkness into his wonderful light” (1 Peter 2:9).

Living in God’s kingdom includes being part of a family of faith... the church. We were created to live together in community. We need each other in order to live fully as “the body of Christ.”

And the only way such a diverse group can live in harmony is under the control of the Holy Spirit. We must “be completely humble and gentle; be patient, bearing with one another in love. Make every effort to keep the unity of the Spirit through the bond of peace” (Ephesians 4:2-3).

These Adult Bible Study groups are part of our church’s strategy “to prepare God’s people for works of service, so that the body of Christ may be built up until we all reach unity in the faith and in the knowledge of the Son of God and become mature, attaining to the whole measure of the fullness of Christ” (Ephesians 4:12-13).

We have tried to organize ourselves to address the unique challenges and opportunities of each stage of life. Check out the options provided here and select one or two to visit. We look forward to getting to know you better!



## 20 - 35

<b>DEPARTMENT</b>	<b>LOCATION</b>	<b>CLASS TYPE</b>
King/Stidham Grad & Career	Room 300	Coed, Single Adults, 30s
Howerton/Taylor Foundation	Room 319	Engaged, Newly Married (Some with Younger Children)
Leman Rooted	Room 317	Families with Babies through Elementary age Children
Kulesz Yellow Submarine	Room 324	Coed, All Life Stages Single, Divorced, Married
Crow Launch	Room 302	Coed, 20-25



## 35 - 55

<b>DEPARTMENT</b>	<b>LOCATION</b>	<b>CLASS TYPE</b>
Allovio/Coe	Room 202	Coed, Singles
Richardson	Room 204	Coed, Married
Caffey/O'Neal	Room 208	Coed
Cunningham	Room 206	Coed, Married
Cheung 中英文主日学	Room 225	Coed. All ages, (English, Chinese, ESL Bible study)
Tucker	Room 233	Coed
Tate/Kennemer	Room 224	Coed



## 55 - 75

<b>DEPARTMENT</b>	<b>LOCATION</b>	<b>CLASS TYPE</b>
Goble	Room 200	Coed, Singles
Hawkins/Bethel	Room 228	Coed
Williams	The Loft	Men's and Women's Classes
Bourgeois	Room 201	Coed
Barry	Room 223	Coed
Bishop	Room 226	Coed



## 75 & UP

<b>DEPARTMENT</b>	<b>LOCATION</b>	<b>CLASS TYPE</b>
Goodyear	Chapel	Coed
Collins/Sakdinawat	Room 142	Coed
Graves	Room 123	Coed
Acreback	Room 141	Coed, Married
Meek/Stewart	Room 230	Coed, Men's and Women's Classes

**CONT'D ON NEXT PAGE**

## 75 & UP CONT'D

West	Room 237	Coed
Graham	Room 146	Coed
McClung/Adair	Room 111	Coed, Men's and Women's Classes
Dove/Williams	Room 140	Coed
Burk	Room 145	Women



# ADDITIONAL MINISTRIES

DEPARTMENT	LOCATION	CLASS TYPE
Special Ministries	Room 138	Special Needs
Cheung 中英文主日学	Room 225	Coed. All ages, (English, Chinese, ESL Bible study)
Dowdy	Room 231	Coed, All ages, <b>Meets at 8am</b>

- **Preschool classes**, from infants to Kindergarten, meet on the first floor of the Preschool/Children's building.
- **Children's classes**, from 1st to 6th grade, meet on the second floor of the Preschool/Children's building.
- **Youth classes**, from 7th to 12th grade, meet in the Student Building, Room 100
- **College class**, meets in the Student Building, Room 150

**ALL CLASSES ARE DURING THE 9:45 SUNDAY SCHOOL HOUR**

# 1ST FLOOR OF MAIN BUILDING

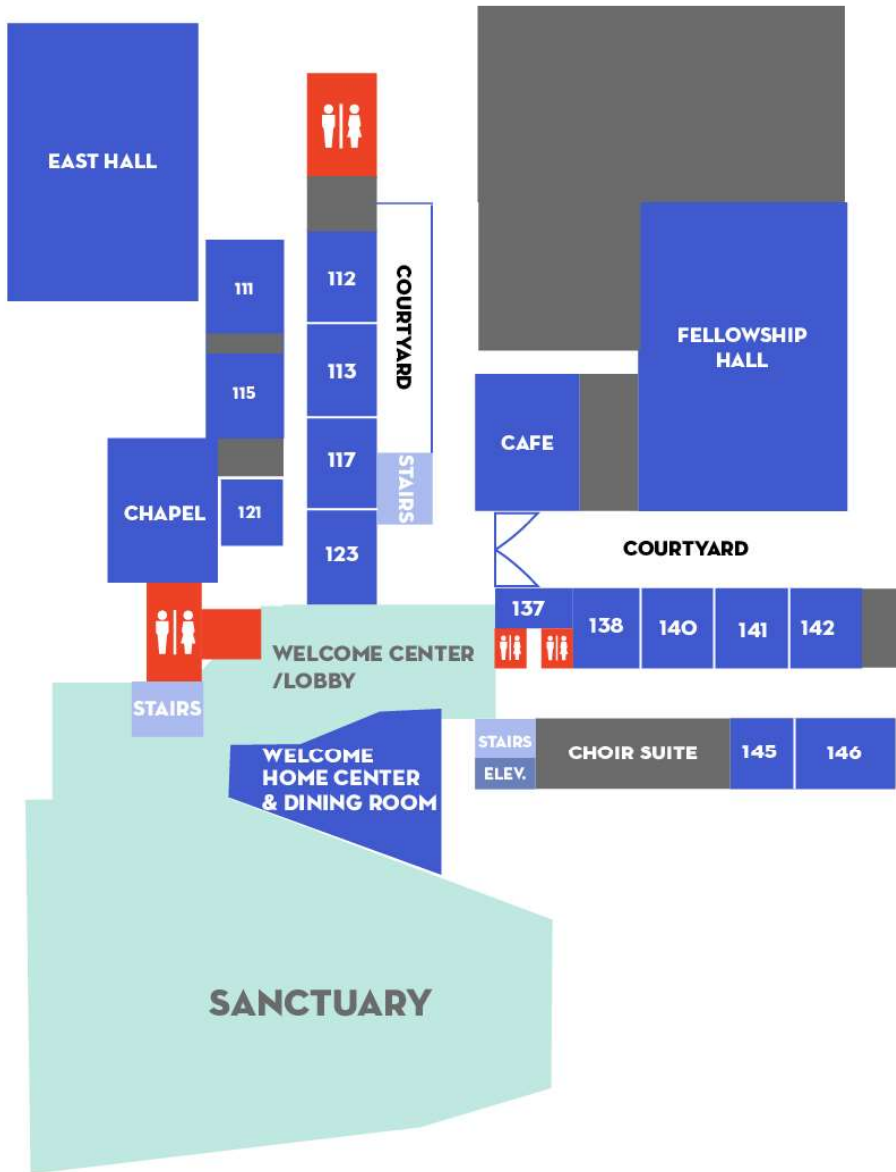



# 2ND FLOOR OF MAIN BUILDING

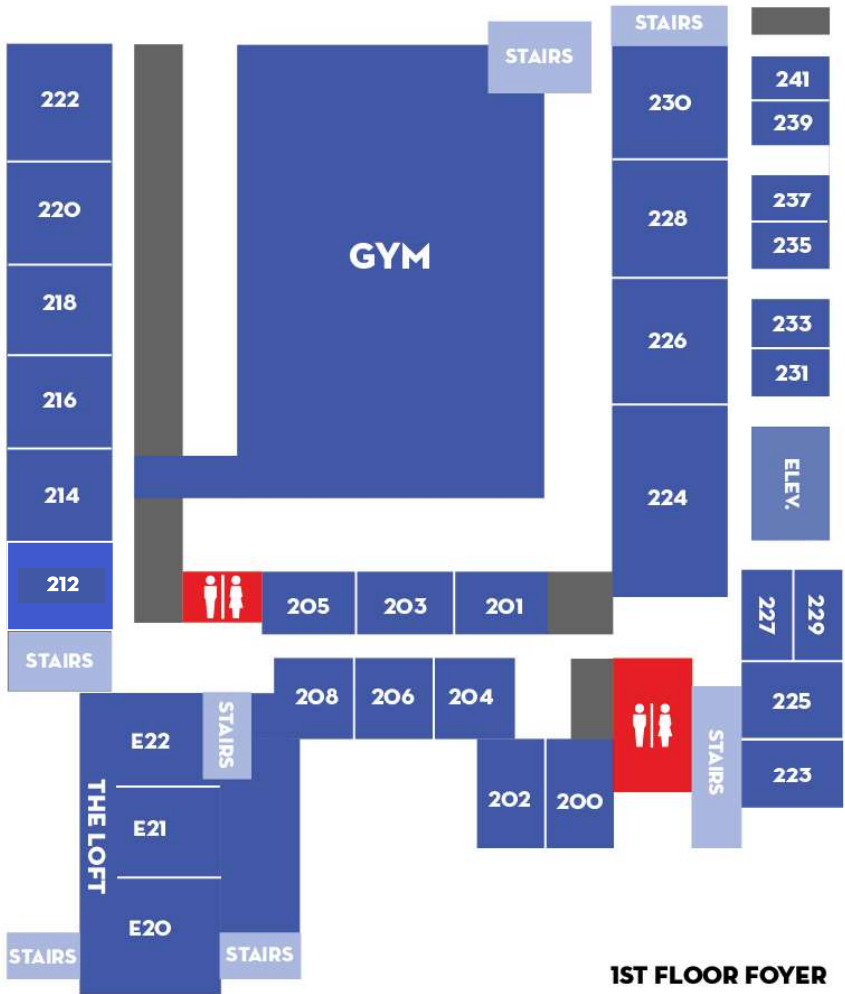



# 3RD FLOOR OF MAIN BUILDING

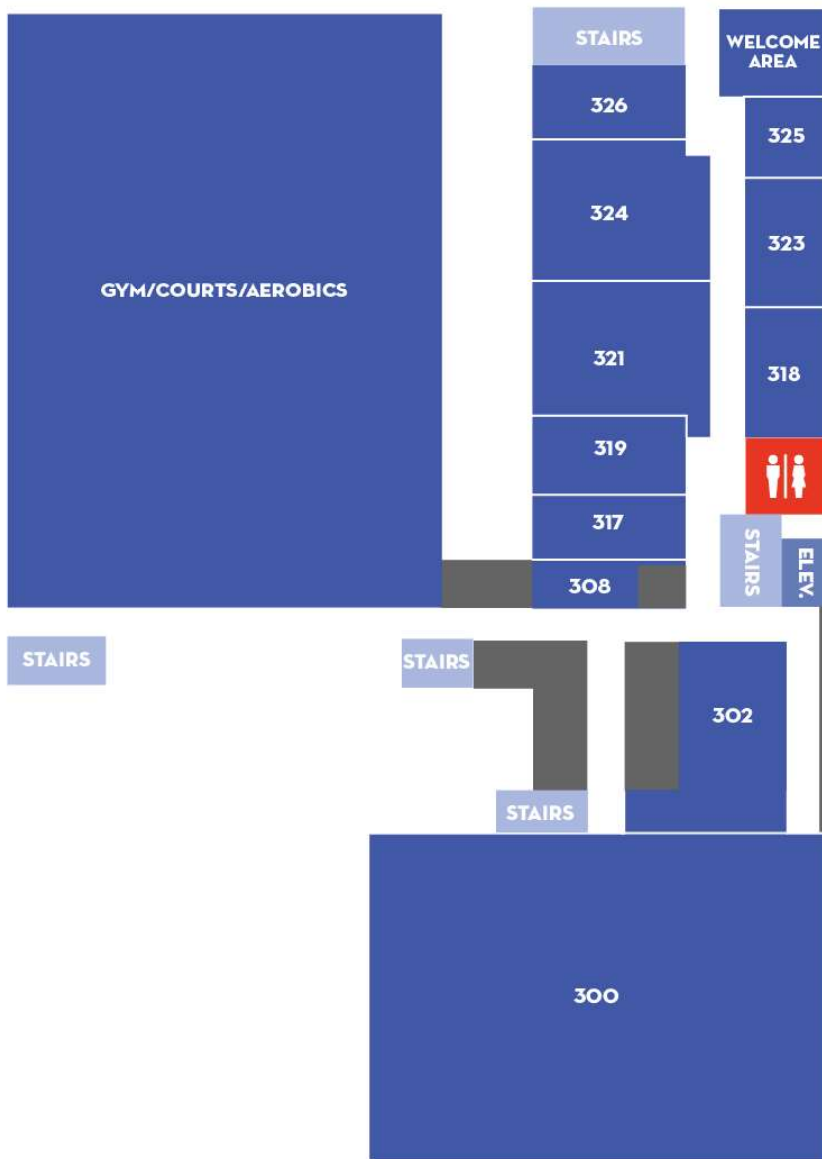



# PSALM 1

"They are like trees planted along the riverbank, bearing fruit each season. Their leaves never wither, and they prosper in all they do" (Psalm 1:3).

We use the imagery of Psalm 1 to help illustrate what spiritual growth looks like. We want to be Psalm 1 people who live as a Psalm 1 church. As we "glorify God by following The Jesus Way," we're on a journey of spiritual formation together. We're being transformed from the inside out as we orient our lives toward him.

There are 3 parts to the Psalm 1 Tree we want to focus on.

## **IMPACT** (influence)... fruitful branches

*"What is God doing through me?"*

Ultimately, our lives should impact the world around us. God blesses us so that we can be a blessing to others. Followers of Jesus have been gifted to serve. We are called to be "salt" and "light" in our community. Your life must be oriented around the Word of God.

## **GROWTH** (transformation)... strong trunk

*"What is God doing to me?"*

In order for a tree to reach its full potential - supporting the weight of fruitful branches - it has to have a strong trunk. Spiritual formation is a life-long process of learning and discovery. Your worldview must be shaped by the Word of God.

## **IDENTITY** (purpose)... deep roots

*"Who am I?"*

The key to a healthy tree is a good root system. Your "deep roots" come from knowing who you are in Christ. Your identity is based on your relationship with Jesus. Your understanding of who you are must be informed by the Word of God.

God expects us to keep growing and maturing throughout our lives. He wants us to be healthy and productive for his glory as we follow The Jesus Way.

“So then, just as you received Christ Jesus as Lord, continue to live your lives in him, rooted and built up in him, strengthened in the faith as you were taught, and overflowing with thankfulness” (Colossians 2:6-7).

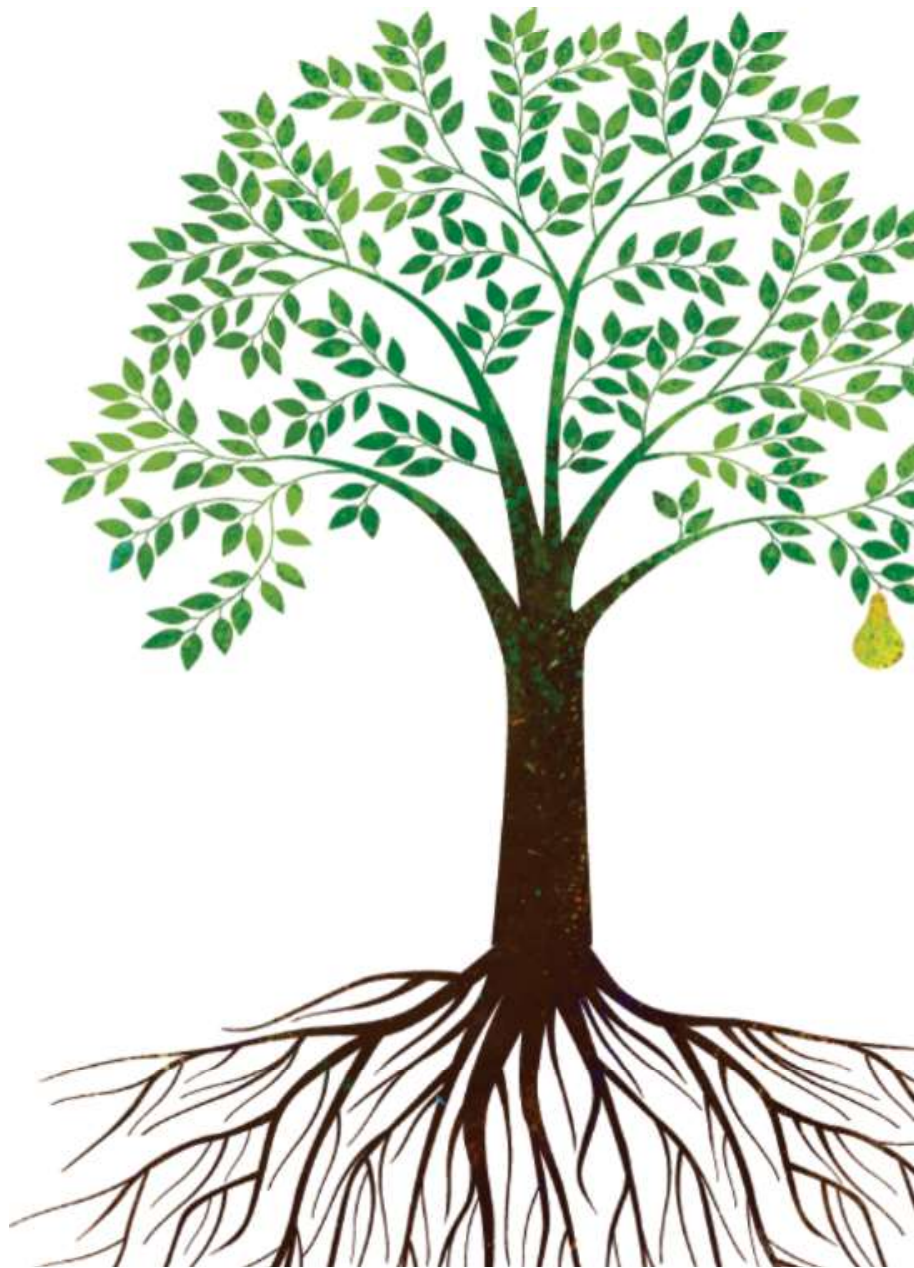



FIRST BAPTIST **ARLINGTON**

Dr. Dennis Wiles, *Senior Pastor*

301 S. Center St | Suite 500 | Arlington TX 76010

Spiritual Formation Phone: 817.276.6435

817.277.6353 | [fbca.org](http://fbca.org)